

LSEG

WORKSPACE ADD-INS

WORKSPACE INSTALLATION GUIDE

Access to LSEG® data and tools is provided through either of the following separately installed add-ins. These tools provide an additional menu ribbon in certain Microsoft® Office apps, where:

– **Workspace**

This add-in is the core product, which has a comprehensive set of capabilities. This add-in is the recommended add-in for most users.

– **Workspace Lite**

This add-in provides basic capabilities and is typically recommended for macOS and web browser-based environments due to its functional limitations.

This document describes the pre-requisites and installation of the **Workspace** add-in.

Pre-requisites

The following facilities must be installed or configured for tools within the menu ribbon to be made available.

Installing required Microsoft components

To use the **Workspace** add-in, install the following application:

- [Microsoft Edge WebView2 Runtime](#)

Microsoft 365 Trust Center policy settings

Certain groups under the Workspace add-in ribbons contain web-based capabilities¹. As such, for these capabilities to be made available, the Group and/or Trust Center policies must be set to allow use of Web add-ins, otherwise they do not load.

To enable the use of Web add-ins, do the following:

1. Open a Microsoft 365 file (Word, Excel, ...).
2. Open the **File** menu.
3. Select **Options**.
4. In the Options dialog, select **Trust Center**.
5. Click the **Trust Center Settings...** button.
6. Select **Trusted Add-in Catalogs**.

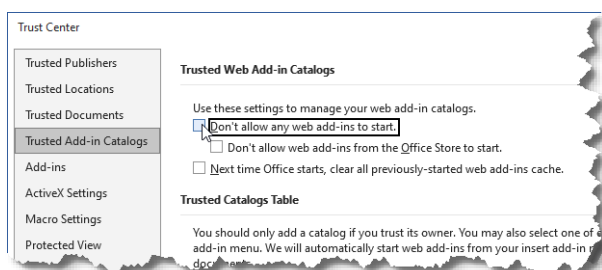

7. Uncheck the **Don't allow any web add-ins to start** checkbox.

Installing the Office add-ins

The **Workspace** add-in² is installed automatically when you [download](#) and [install](#) LSEG Workspace for desktop.

Make sure that your PC hardware and the operating system meet the required levels. For further information, refer to the [LSEG Workspace System Requirements](#).

Additional information

For more detailed information regarding:

- Microsoft 365/Office version requirements, browser compatibility, and tools supported by each add-in, refer to the [Workspace Add-Ins - System Requirements](#).
- Prerequisites, installation, and deployment instructions for the required add-in, refer to:
 - This document for **Workspace** installation guidance, or
 - the [Workspace Add-Ins – Workspace Lite Installation Guide](#).

Known issues

Workspace installations without automatic update

For users installing LSEG Workspace using `--machine-autoupdate=no`, the Excel add-in will not load correctly on non-virtual machines. This is because the default location of the Office registry key is registered at HKLM.

To correct the registry key location, use the command:

```
<install path>/RefinitivWorkspace.exe --update-office-registry=HKCU
```

For more information, see [PCN206237](#).

¹ Web-based capabilities include Deals BI, Linking, Hotkeys, Traces, Auto Color, Define Palette, Comp List, Annotations, and Logos.

² This add-in only works for Windows users. If you are a Mac user, refer to the [Workspace Add-Ins – Workspace Lite Installation Guide](#).

